

---

STATUTORY INSTRUMENTS

---

**2014 No. 501 (S. 1)**

**CONSTITUTIONAL LAW  
DEVOLUTION, SCOTLAND**

**The Scottish Parliament (Constituencies  
and Regions) Order 2014**

*Made - - - - 5th March 2014  
Coming into force in accordance with article 1(2) and  
(3)*

In accordance with paragraph 3(6) of Schedule 1 to the Scotland Act 1998<sup>(1)</sup>, the Boundary Commission for Scotland submitted to the Secretary of State a report dated October 2013 relating to the boundaries at Princes Gate and Greenacres by Robroyston.

In accordance with paragraph 3(9) of that Schedule a copy of that report and a draft of this Order in Council to give effect to the recommendations contained in the report were laid before Parliament by the Secretary of State.

In accordance with paragraph 6(2) of that Schedule the draft was approved by a resolution of each House of Parliament.

Accordingly, Her Majesty, in exercise of the powers conferred upon Her by paragraph 6(1) and (5) of that Schedule, is pleased, by and with the advice of Her Privy Council, to order as follows:

**Citation, commencement and interpretation**

**1.** (1) This Order may be cited as the Scottish Parliament (Constituencies and Regions) Order 2014.

(2) Except for article 4, this Order comes into force on the day after the day on which it is made<sup>(2)</sup>.

(3) Article 4 comes into force on the dissolution of the Parliament.

(4) In this Order “the Act” means the Scotland Act 1998.

---

(1) 1998 c.46. Schedule 1 was substituted by the Scottish Parliament (Constituencies) Act 2004 (c.13) and amended by the Scotland Act 2012 (c.11).

(2) By virtue of 6(7) of Schedule 1 to the Scotland Act 1998 the coming into force of this Order does not affect the return of any member to the Scottish Parliament or its constitution until the Scottish Parliament is dissolved.

## Constituencies

2. (1) For the purposes of paragraph 1(2)(c) of Schedule 1 to the Act, the constituencies provided for are those which—

- (a) are named in column 1 of the table in Schedule 1 to this Order; and
- (b) comprise the areas described for each such constituency in the deposited data.

(2) In paragraph (1)(b) the “deposited data” means the data recorded on the DVD-ROMs—

- (a) entitled “Interim Review of Scottish Parliament Boundaries at Princes Gate and Greenacres by Robroyston – master copy submitted to the Secretary of State for Scotland”;
- (b) etched with the seal of the Boundary Commission for Scotland and the signatures of its deputy Chairman and Secretary;
- (c) submitted to the Secretary of State for Scotland on 31 October 2013; and
- (d) deposited with him at his offices at 1 Melville Crescent, Edinburgh, EH3 7HW.

(3) The constituencies are designated as being either county constituencies or burgh constituencies according to the entry in column 2 of Schedule 1 opposite each constituency name.

## Regions

3. For the purposes of paragraph 2(2) of Schedule 1 to the Act, the regions provided for are those which—

- (a) are named in column 1 of the table in Schedule 2 to this Order; and
- (b) comprise the combined areas of the constituencies mentioned in column 2 of that table opposite the name of each region.

## Revocation

4. The Scottish Parliament (Constituencies and Regions) Order 2010(3) is revoked.

*Richard Tilbrook*  
Clerk of the Privy Council

---

(3) [S.I. 2010/2691](#). Article 3 of [S.I. 2010/2691](#) amended paragraphs 1(2)(c) and 2(2) of Schedule 1 to the Scotland Act 1998. These paragraphs were amended by paragraphs 8 and 9 of Schedule 1 to the Scotland Act 2012 (c.11).

SCHEDULE 1

Article 2

Scottish Parliament Constituencies

*(other than Orkney Islands and Shetland Islands Constituencies)*

<i>Column 1</i> <i>Constituency Name</i>	<i>Column 2</i> <i>Designation</i>
Aberdeen Central	Burgh
Aberdeen Donside	Burgh
Aberdeen South and North Kincardine	County
Aberdeenshire East	County
Aberdeenshire West	County
Airdrie and Shotts	Burgh
Almond Valley	County
Angus North and Mearns	County
Angus South	County
Argyll and Bute	County
Ayr	Burgh
Banffshire and Buchan Coast	County
Caithness, Sutherland and Ross	County
Carrick, Cumnock and Doon Valley	County
Clackmannanshire and Dunblane	County
Clydebank and Milngavie	County
Clydesdale	County
Coatbridge and Chryston	Burgh
Cowdenbeath	County
Cumbernauld and Kilsyth	County
Cunninghame North	County
Cunninghame South	County
Dumbarton	County
Dumfriesshire	County
Dundee City East	Burgh
Dundee City West	Burgh
Dunfermline	County
East Kilbride	Burgh
East Lothian	County

---

*Status: This is the original version (as it was originally made). This item of legislation is currently only available in its original format.*

---

<i>Column 1</i>	<i>Column 2</i>
<i>Constituency Name</i>	<i>Designation</i>
Eastwood	County
Edinburgh Central	Burgh
Edinburgh Eastern	Burgh
Edinburgh Northern and Leith	Burgh
Edinburgh Pentlands	Burgh
Edinburgh Southern	Burgh
Edinburgh Western	Burgh
Na h-Eileanan an Iar	County
Ettrick, Roxburgh and Berwickshire	County
Falkirk East	County
Falkirk West	County
Galloway and West Dumfries	County
Glasgow Anniesland	Burgh
Glasgow Cathcart	Burgh
Glasgow Kelvin	Burgh
Glasgow Maryhill and Springburn	Burgh
Glasgow Pollok	Burgh
Glasgow Provan	Burgh
Glasgow Shettleston	Burgh
Glasgow Southside	Burgh
Greenock and Inverclyde	County
Hamilton, Larkhall and Stonehouse	Burgh
Inverness and Nairn	County
Kilmarnock and Irvine Valley	County
Kirkcaldy	County
Linlithgow	County
Mid Fife and Glenrothes	County
Midlothian North and Musselburgh	County
Midlothian South, Tweeddale and Lauderdale	County
Moray	County
Motherwell and Wishaw	Burgh
North East Fife	County
Paisley	Burgh
Perthshire North	County

<i>Column 1</i> <i>Constituency Name</i>	<i>Column 2</i> <i>Designation</i>
Perthshire South and Kinross-shire	County
Renfrewshire North and West	County
Renfrewshire South	County
Rutherglen	Burgh
Skye, Lochaber and Badenoch	County
Stirling	County
Strathkelvin and Bearsden	County
Uddingston and Bellshill	Burgh

---

SCHEDULE 2

Article 3

Scottish Parliament Regions

<i>Column 1</i> <i>Region</i>	<i>Column 2</i> <i>Constituency Name</i>
Central Scotland	Airdrie and Shotts
	Coatbridge and Chryston
	Cumbernauld and Kilsyth
	East Kilbride
	Falkirk East
	Falkirk West
	Hamilton, Larkhall and Stonehouse
	Motherwell and Wishaw
	Uddingston and Bellshill
	Glasgow
	Glasgow Cathcart
	Glasgow Kelvin
	Glasgow Maryhill and Springburn
	Glasgow Pollok
	Glasgow Provan
	Glasgow Shettleston
	Glasgow Southside
	Rutherglen
Highlands and Islands	Argyll and Bute

---

**Status:** This is the original version (as it was originally made). This item of legislation is currently only available in its original format.

---

<i>Column 1</i> Region	<i>Column 2</i> Constituency Name
	Caithness, Sutherland and Ross
	Na h-Eileanan an Iar
	Inverness and Nairn
	Moray
	Orkney Islands
	Shetland Islands
	Skye, Lochaber and Badenoch
Lothian	Almond Valley
	Edinburgh Central
	Edinburgh Eastern
	Edinburgh Northern and Leith
	Edinburgh Pentlands
	Edinburgh Southern
	Edinburgh Western
	Linlithgow
	Midlothian North and Musselburgh
Mid Scotland and Fife	Clackmannanshire and Dunblane
	Cowdenbeath
	Dunfermline
	Kirkcaldy
	Mid Fife and Glenrothes
	North East Fife
	Perthshire North
	Perthshire South and Kinross-shire
	Stirling
North East Scotland	Aberdeen Central
	Aberdeen Donside
	Aberdeen South and North Kincardine
	Aberdeenshire East
	Aberdeenshire West
	Angus North and Mearns
	Angus South
	Banffshire and Buchan Coast
	Dundee City East

<i>Column 1</i> Region	<i>Column 2</i> Constituency Name
South Scotland	Dundee City West
	Ayr
	Carrick, Cumnock and Doon Valley
	Clydesdale
	Dumfriesshire
	East Lothian
	Ettrick, Roxburgh and Berwickshire
	Galloway and West Dumfries
	Kilmarnock and Irvine Valley
	Midlothian South, Tweeddale and Lauderdale
West Scotland	Clydebank and Milngavie
	Cunninghame North
	Cunninghame South
	Dumbarton
	Eastwood
	Greenock and Inverclyde
	Paisley
	Renfrewshire North and West
	Renfrewshire South
	Strathkelvin and Bearsden

---

---

## EXPLANATORY NOTE

*(This note is not part of the Order)*

This Order gives effect to the recommendations contained in the Report on Interim Review of Scottish Parliament Boundaries at Princes Gate and Greenacres by Robroyston by the Boundary Commission for Scotland dated October 2013. The report is available on the Boundary Commission for Scotland's website ([www.bcomm-scotland.gov.uk](http://www.bcomm-scotland.gov.uk)) or in hard copy from The Stationery Office ([www.tso.co.uk](http://www.tso.co.uk) Tel: 0870 600 5522).

The report recommends changes to the constituency boundaries between Glasgow Provan constituency and Strathkelvin and Bearsden constituency and the region boundaries between Glasgow region and West Scotland region as set out by the Scottish Parliament (Constituencies

*Status: This is the original version (as it was originally made). This item of legislation is currently only available in its original format.*

and Regions) Order 2010 (S.I. 2010/2691). An indicative map of the changes being made to these constituencies and regions is included in this note.

The Order defines the name, status and area of 71 of the 73 Scottish Parliament constituencies and the name and area of each Scottish Parliament region. (The Orkney Islands constituency and the Shetland Islands constituency are not included in the Order because Schedule 1 to the Scotland Act 1998 (“the 1998 Act”) provides for them directly). Other than the changes made to the Glasgow Provan constituency and Strathkelvin and Bearsden constituency and the Glasgow region and West Scotland region, the constituencies and regions are the same as provided by the Scottish Parliament (Constituencies and Regions) Order 2010.

The Order comes into force on the day after it is made (with the exception of article 4). It does not affect the return of any member to the Parliament or its constitution until the Parliament is dissolved (paragraph 6(7) of Schedule 1 to the 1998 Act). It does apply to any proceedings which occur before dissolution but which relate to a poll which will take place after dissolution.

The 71 constituencies are named and defined by article 2 read together with Schedule 1. The area of each constituency is described in geographical information system data stored on a set of DVD-ROMs deposited with the Secretary of State for Scotland. The DVD-ROMs are entitled “Interim Review of Scottish Parliament Boundaries at Princes Gate and Greenacres by Robroyston” and set out the area of each constituency, taking account of the changes recommended by the Boundary Commission for Scotland. Maps of the boundaries are available on the Boundary Commission for Scotland’s website and hard copies can be requested by writing to the Commission.

Each constituency is (by article 2(3) and Schedule 1) given the status of a burgh constituency or a county constituency. That status is relevant to the application of rules governing the conduct of elections to the Scottish Parliament (provided for under section 12 of the 1998 Act).

The regions are named and defined by article 3 read together with Schedule 2.

An impact assessment has not been produced for this instrument as no impact on business or the private or voluntary sector is foreseen.

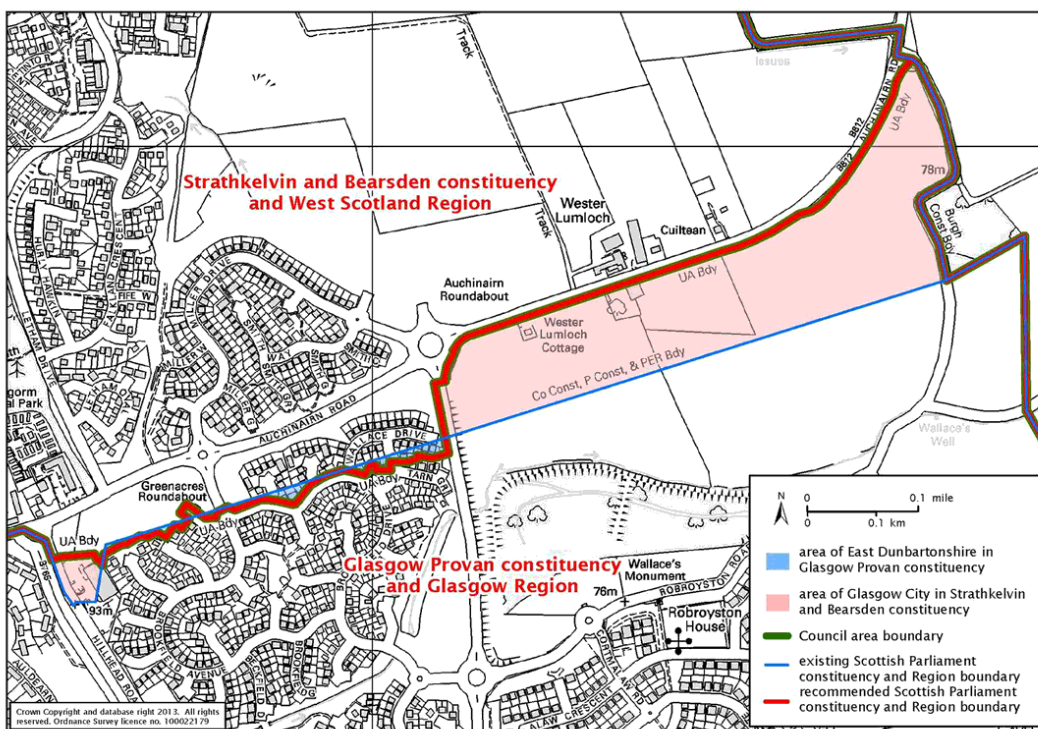



---

**Status:** *This is the original version (as it was originally made). This item of legislation is currently only available in its original format.*

---