

2019 No. 1147

HIGHWAYS, ENGLAND

The A556 Trunk Road (M6 Junction 19 Improvement Northbound and Southbound Link Roads) Order 2019

Made - - - - *16th July 2019*

Coming into force - - *1st August 2019*

The Secretary of State for Transport makes this Order in exercise of powers conferred by section 10 of the Highways Act 1980(a), and now vested in him(b):

1. This Order may be cited as The A556 Trunk Road (M6 Junction 19 Improvement Northbound and Southbound Link Roads) Order 2019 and shall come into force on the date on 1st August 2019.

2. In this Order –

(a) all measurements of distance are measured along the route of the relevant highway;

(b) –

(i) “Highways England” means Highways England Company Limited, which is a strategic highways company (Company No 9346363) registered in England and Wales and whose Registered Office is Bridge House, Walnut Tree Close, Guildford, Surrey, GU1 4LZ

(ii) “the new trunk roads” means the new link roads which are proposed to be constructed by Highways England along the routes described in the Schedule to this Order, and

(iii) “the plan” means the plan numbered A556/M6J19S10NEWTRS2018 marked “The A556 Trunk Road (M6 Junction 19 Improvement Northbound and Southbound Link Roads) Order 2019, “signed by authority of the Secretary of State for Transport and deposited at, Deposited Documents, Records Management Unit, Highways England, Lateral, 8 City Walk, Leeds, LS11 9AT.

3. The centre line of each of the new trunk roads is indicated by a heavy black line on the plan.

4. The Secretary of State for Transport hereby directs that the new trunk roads shall become trunk roads from the date when this Order comes into force and that Highways England, as a strategic highways company, shall become the highway authority for those trunk roads from that date.

Signed by authority of the Secretary of State for Transport

16th July 2019

Simon Connick

A Senior Civil Servant in the Department for Transport

THE SCHEDULE

ROUTES OF THE NEW TRUNK ROADS

Regulation 3

The routes of the new trunk roads are in the Parish of Tabley Superior, in the Unitary Authority area of Cheshire East, in the County of Cheshire, and are:

1. A route 186 metres in length, from a point on the inner arc of the A556 Trunk Road roundabout at M6 Junction 19, opposite the termination point of the M6 Motorway southbound exit slip road with the A556 Trunk Road roundabout, generally southwards to a point on the inner arc of the A556 Trunk Road roundabout, opposite where the southbound carriageway of the A556 Principal Road exits from the roundabout junction (marked 1 on the plan).

2. A route 212 metres in length from a point on the inner arc of the A556 Trunk Road roundabout at M6 Junction 19, opposite the termination point of the M6 Motorway northbound exit slip road with the A556 Trunk Road roundabout, generally north westwards to a point on the inner arc of the A556 Trunk Road roundabout, opposite where the northbound carriageway of the A556 Trunk road meets with that roundabout (marked 2 on the plan).

THE A556 TRUNK ROAD
(M6 JUNCTION 19 IMPROVEMENT NORTHBOUND AND
SOUTHBOUND LINK ROADS) ORDER 2019

This Plan shows the centre line of the new Trunk Roads
but not the widths or construction details

KEY

CENTRE LINE OF THE NEW TRUNK ROADS _____

Plan Scale 1:2,500

PLANS REGISTRY NO.
A556/M6J19S10NEWTRS2018

SIGNED BY AUTHORITY OF THE
SECRETARY OF STATE FOR TRANSPORT
ON THE 16TH JULY 2019

A SENIOR CIVIL SERVANT IN THE
DEPARTMENT FOR TRANSPORT

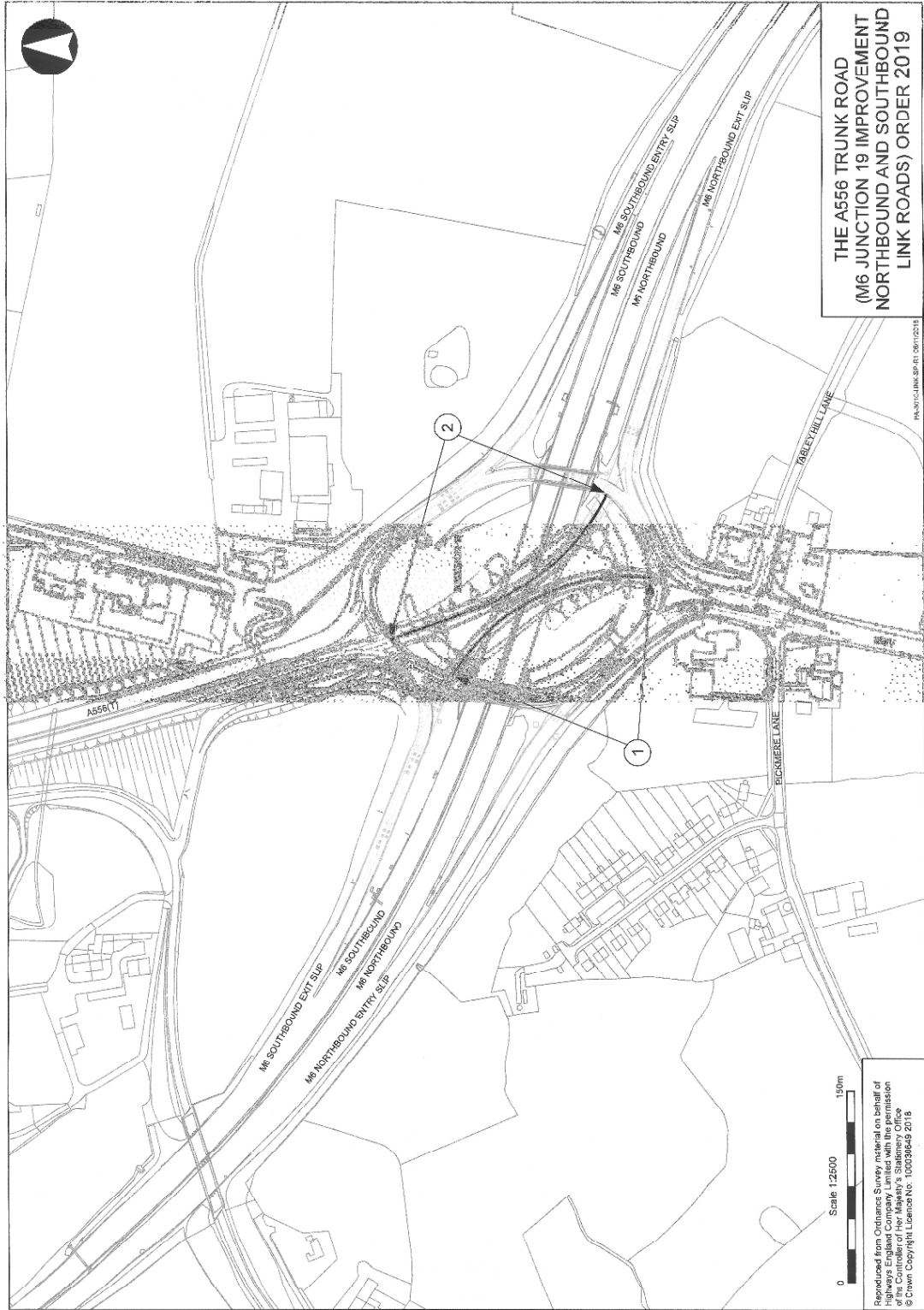

EXPLANATORY NOTE

(This note is not part of the Order)

Highways England Company Limited are authorised to construct two new link roads of the A556 Trunk Road as described in the above Schedule, running through the centre of the A556 Trunk Road roundabout at M6 Junction 19, and crossing over the M6 Motorway on a new bridge. This Order designates the new link roads as trunk roads from the date this Order comes into force and Highways England Company Limited as the highways authority for the new link roads from that date.

The new link roads will provide a more direct route through the roundabout for traffic travelling from the M6 Motorway southbound to the A556 Principal Road southbound, and the M6 Motorway northbound to the A556 Trunk Road northbound, respectively, removing the need for such directional traffic to use the circulatory carriageway of the A556 Trunk Road roundabout.

These additional link roads, together with the light control of traffic movement at the A556 Trunk Road roundabout entry and exit points, will provide greater capacity and free flow of traffic movement at the M6 Junction 19/A556 Trunk Road roundabout junction.

© Crown copyright 2019

Printed and published in the UK by The Stationery Office Limited under the authority and superintendence of Jeff James, Controller of Her Majesty's Stationery Office and Queen's Printer of Acts of Parliament.

£4.90

UK201907171013 07/2019 19585

<http://www.legislation.gov.uk/id/uksi/2019/1147>

ISBN 978-0-11-118887-3

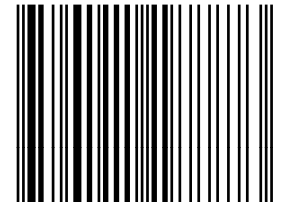

9 780111 188873