STATUTORY INSTRUMENTS

2020 No. 564

HIGHWAYS, ENGLAND

The A2 Trunk Road (Bean and Ebbsfleet Junction Improvements) (Slip Roads and Roundabouts) Order 2020

Made - - - - 27th May 2020
Coming into force - - 11th June 2020

The Secretary of State for Transport makes this Order in exercise of powers conferred by sections 10(2)(a)(i), (3) and (3A) of the Highways Act 1980(1) and now vested in him(2):

In accordance with section 10(2) of that Act, the Secretary of State has taken into consideration the requirements of local and national planning, including the requirements of agriculture, and is satisfied as to expediency.

This Order is made in compliance with the provisions of Parts I and III of Schedule 1 to that Act.

1. This Order may be cited as the A2 Trunk Road (Bean and Ebbsfleet Junction Improvements) (Slip Roads and Roundabouts) Order 2020 and shall come into force on 11th June 2020.

2. In this Order –

- (1) all measurements of distance are measured along the route of the relevant highway;
- (2) –

(a)	“Highways England”	means Highways England Company Limited, which is a strategic highways company (Company No. 9346363), which is a company registered in England and Wales and whose Registered Office is Bridge House, Walnut Tree Close, Guildford, Surrey, GU1 4LZ;
(b)	“the plan”	means one of the plans marked “Key Plan”, “Site Plan 1” and “Site Plan 2” contained in the plan folio numbered HE/10/MP/001 and marked “The A2 Trunk Road (Bean and Ebbsfleet Junction Improvements) (Slip

(1) 1980 c 66. Section 10 is amended by the New Roads and Street Works Act 1991 (c. 22), section 22(2)(a), and the Infrastructure Act 2015 (c. 7), paragraph 10(2) and (3) of Schedule 1. There are further amendments to section 10 which are not relevant to this Order.
(2) S.I. 1981/238.

Status: This is the original version (as it was originally made). This item of legislation is currently only available in its original format.

Roads and Roundabouts) Order 2020”, signed by authority of the Secretary of State for Transport and deposited at Department for Transport, Room F13, Ashdown House, St Leonards on Sea, Hastings, TN37 7GA and at the office of Highways England Company Limited, Lateral, 8 City Walk, Leeds, LA11 9AT, a duplicate copy has been deposited at the office of the Secretary of State for Transport; and

- (c) “the proposed new trunk roads” means the new slip roads and roundabout extension which are proposed to be constructed by Highways England along the routes described in the Schedule to this Order.

3. The centre line of each of the proposed new trunk roads is indicated by a heavy black line on the plan.

4. The Secretary of State for Transport hereby directs that the proposed new trunk roads shall become trunk roads from the date when this Order comes into force and that Highways England, as a strategic highways company, shall become the highway authority for those trunk roads from that date.

Signed by authority of the Secretary of State for Transport

27th May 2020

Simon Connick
A Senior Civil Servant in the Department for
Transport

SCHEDULE

Regulation 2(2)(c)

ROUTES OF THE SLIP ROADS AND ROUNDABOUT EXTENSION

The lengths of new highways becoming trunk roads are:

(1) Bean Junction:

1. A A2 Trunk Road eastbound entry slip road from the B255 Bean North Roundabout carriageway as proposed to be modified by Highways England to the existing A2 Trunk Road eastbound carriageway. The entry slip road (A-B) along this route being given the number 1 on site plan 1.

2. A A2 Trunk Road westbound entry slip road from the B255 Bean South Roundabout carriageway as proposed to be modified by Highways England to the existing A2 Trunk Road westbound carriageway. The entry slip road (C-D) along this route being given the number 2 on site plan 1.

3. A A2 Trunk Road westbound exit slip road from the existing A2 Trunk Road westbound exit slip carriageway to the B255 Bean South Roundabout carriageway as proposed to be modified by Highways England. The exit slip road (E-F) along this route being given the number 3 on site plan 1.

(2) Ebbsfleet Junction:

1. A A2 Trunk Road eastbound exit slip road from the existing A2 Trunk Road eastbound exit slip carriageway to the Ebbsfleet West Roundabout to Ebbsfleet East Roundabout connector road carriageway as proposed to be modified by Highways England. The exit slip road (G-H) along this route being given the number 4 on site plan 2.

2. A A2 Trunk Road roundabout extension to the Ebbsfleet East Roundabout carriageway as proposed to be modified by Highways England. The partial roundabout extension (J-K) along this route being given the number 5 on site plan 2.

3. A A2 Trunk Road eastbound entry slip road from the Ebbsfleet East Roundabout carriageway as proposed to be modified by Highways England (as (2)2. above) to the existing A2 Trunk Road eastbound carriageway. The entry slip road (L-M) along this route being given the number 6 on site plan 2.

Status: This is the original version (as it was originally made). This item of legislation is currently only available in its original format.

Folio Cover / Maps / Plans referred to in
**THE A2 TRUNK ROAD
(BEAN AND EBBSFLEET JUNCTION IMPROVEMENTS)
(SLIP ROADS AND ROUNDABOUTS) ORDER 2020**

THESE PLANS SHOW THE CENTRE LINES OF THE
NEW TRUNK ROADS BUT NOT THE WIDTHS OR
CONSTRUCTIONAL DETAILS.

KEY:

ROUTES OF THE NEW TRUNK ROADS



Shown for information only

ROUTES OF AMENDED TRUNK ROADS



ROUTES OF OTHER NEW HIGHWAYS



Key Plan Scale 1:25,000
Site Plan Scale 1:5,000

<p>HE PLAN FOLIO NO. HE / 10 / MP / 001</p> <p>23rd October 2018</p>	<p>SIGNED BY AUTHORITY OF THE SECRETARY OF STATE FOR TRANSPORT ON THE 27th May 2020</p> <p>.....</p> <p>A SENIOR CIVIL SERVANT IN THE DEPARTMENT FOR TRANSPORT</p>
---	--

HE54917-ATK-LHA-XX-DR-ZL-000409.dwg

Status: This is the original version (as it was originally made). This item of legislation is currently only available in its original format.



Status: This is the original version (as it was originally made). This item of legislation is currently only available in its original format.

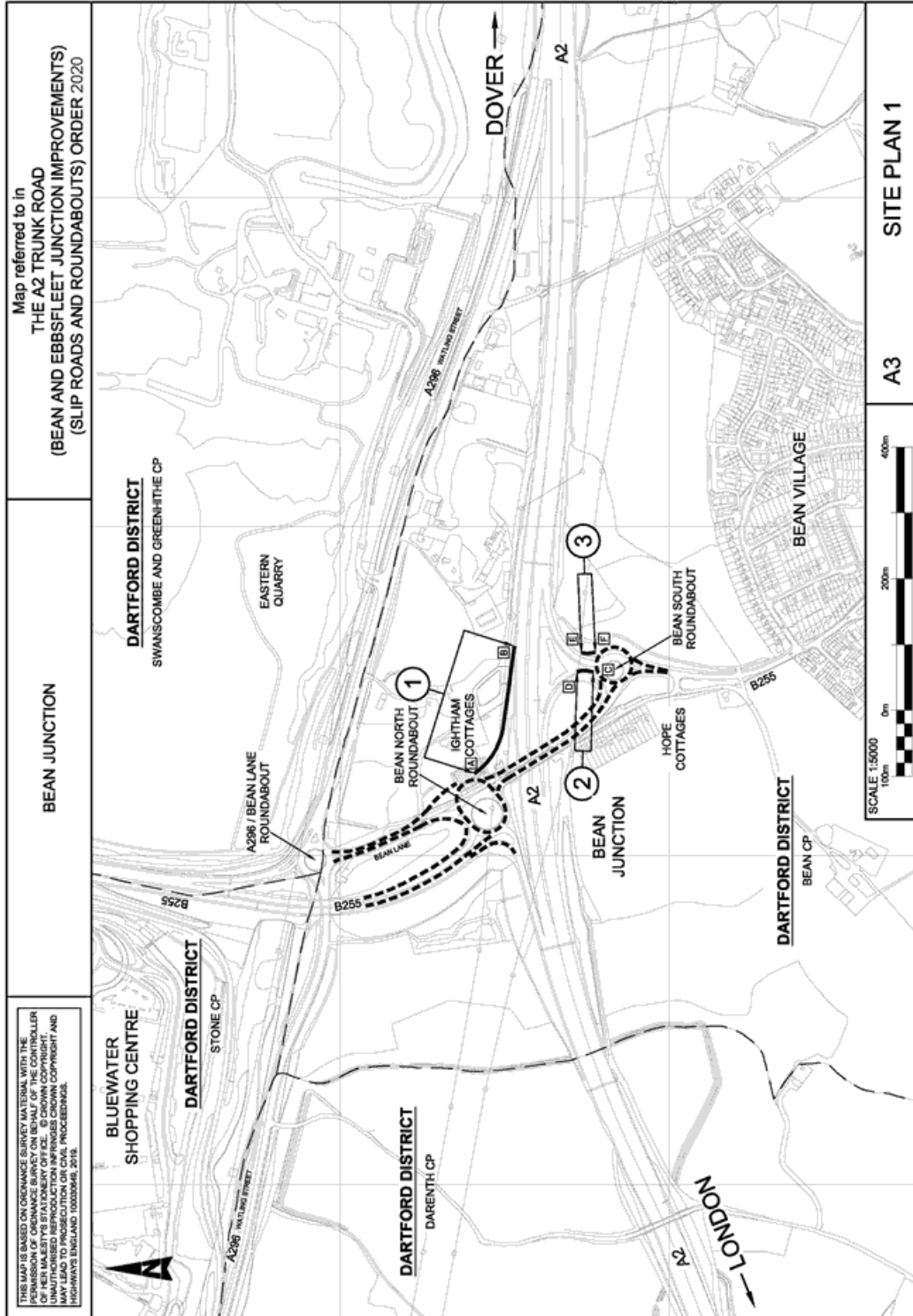

Status: This is the original version (as it was originally made). This item of legislation is currently only available in its original format.

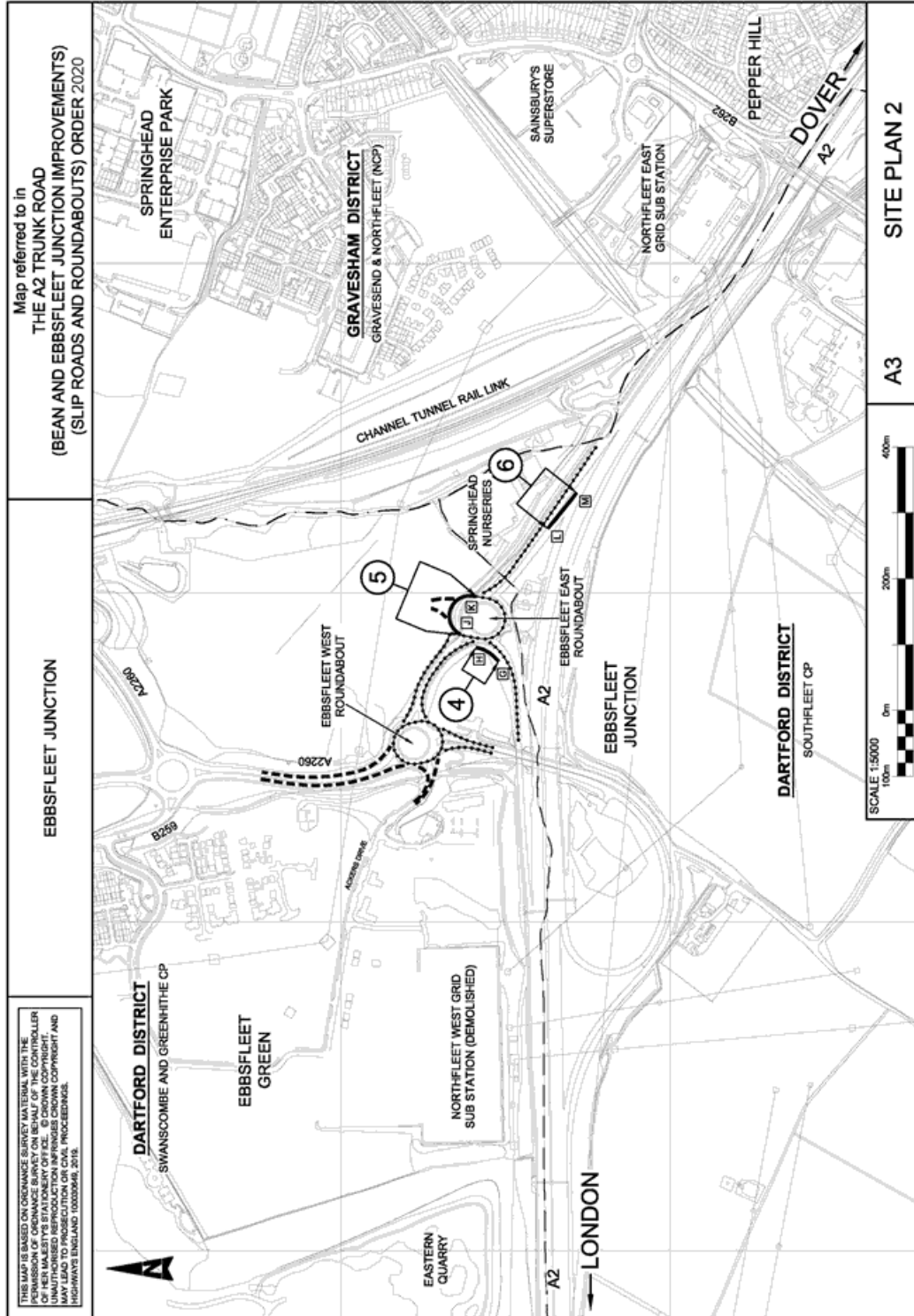

Status: This is the original version (as it was originally made). This item of legislation is currently only available in its original format.

EXPLANATORY NOTE

(This note is not part of the Order)

This Order provides that 5 new slip roads and 1 modified roundabout to connect the A2 Trunk Road to the B255 Bean North and B255 Bean South Roundabouts and Ebbsfleet East Roundabout shall become trunk roads from the date on which this Order comes into force and that Highways England, as a strategic highways company, shall become the highway authority for those trunk roads from that date.